



2 Ranmoor Hill, Hathersage, Hope Valley, Derbyshire, S32 1BU



# 2 Ranmoor Hill Hathersage

Offers In The Region Of

## £415,000

A CHARMING TWO BEDROOM PROPERTY WITH USEFUL OCCASIONAL ROOM/ATTIC

Derbyshire Property with Stunning Panoramic Views over the Hope Valley.

A delightful two-bedroom with mid-terrace cottage enjoying a truly idyllic setting in the heart of the Peak District National Park. Nestling within the sought-after village of Hathersage, the property boasts a large mature rear garden adjoining open countryside, with breathtaking far-reaching views across the glorious Derbyshire landscape.

Hathersage offers an excellent range of local shops, cafés, restaurants, country inns and rail links, whilst remaining within easy commuting distance of major commercial centres.

An attic occasional room with Velux windows is currently used as a third bedroom, offering flexible additional space for guests, hobbies or home working.

The spacious accommodation is full of charm and character and comprises a useful utility/boot room with adjoining WC. A fitted dining kitchen with a range of appliances and range cooker opens through to the welcoming sitting room, featuring a bay window and an attractive fireplace with open fire grate. The sitting room enjoys commanding views across the garden and surrounding countryside, creating a wonderful space to relax. A rear entrance hallway provides direct access to the garden.

Useful Cellar.

To the first floor are two bedrooms, both featuring decorative cast iron fireplaces, together with a family bathroom.

Outside, the property is approached via a pathway leading to an easily maintained front courtyard. A particular feature is the substantial south facing rear garden, beautifully stocked with planted beds and borders, specimen shrubs and mature trees. A seating terrace provides the perfect vantage point to enjoy the simply spectacular panoramic views.



- Simply Stunning Views
- Substantial Well Stocked Rear Garden
- Excellent Village Amenities
- Local Rail Links
- Historic Swimming Pool
- Direct Access To A Wealth Of Local Walks & Outdoor Pursuits
- Good Commutability Links
- Local Primary School & Within Highly Regarded Secondary School Catchment
- EPC: TBC
- Viewings: Hathersage Office



## 2 Ranmoor Hill

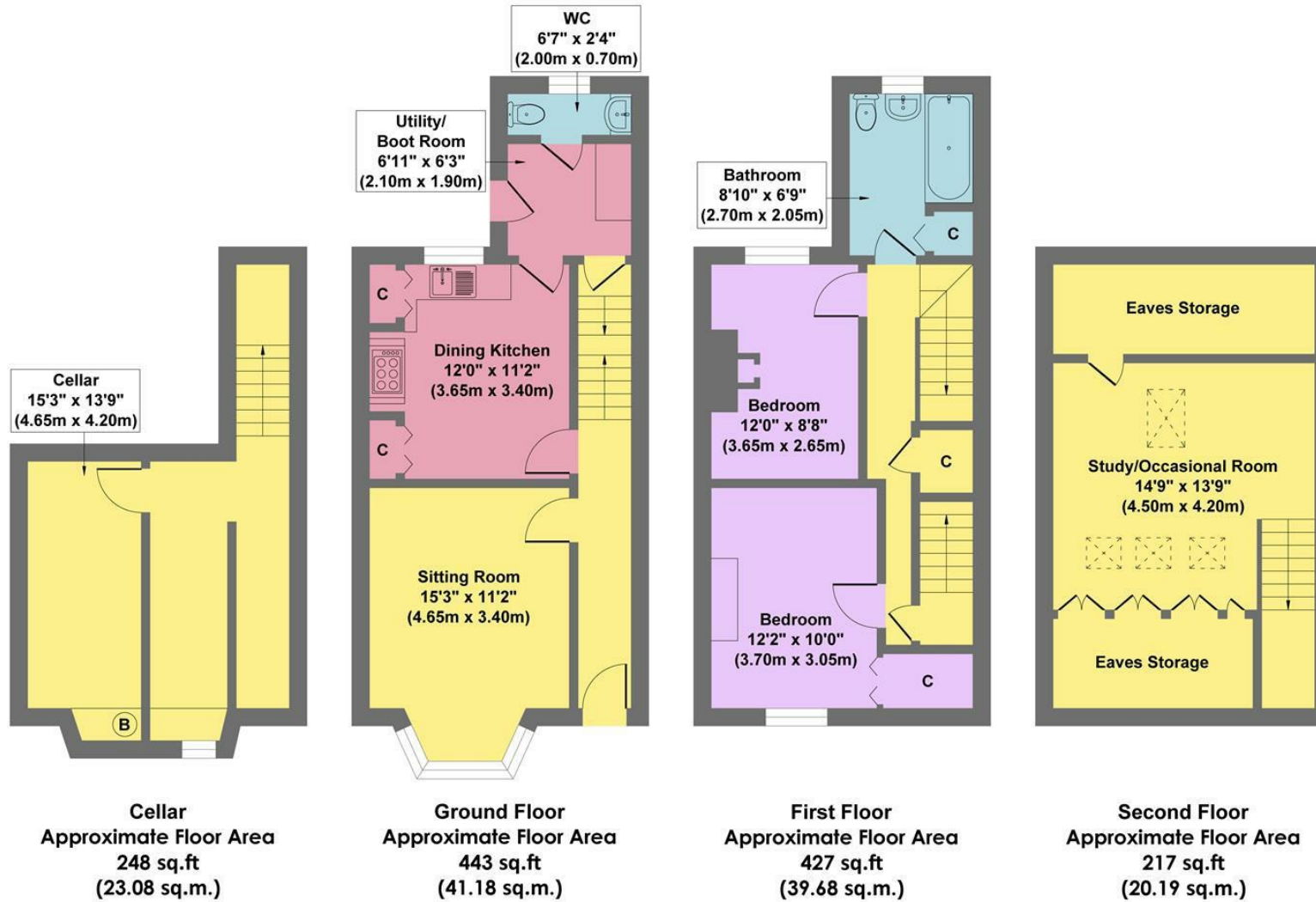

**Approx. Gross Internal Floor Area 1335 sq.ft / 124.13 sq.m**

Illustration for identification purposes only. Measurements are approximate, not to scale

While we endeavour to make our sales particulars fair, accurate and reliable, they are only a general guide to the property and, accordingly, if there is any point, which is of particular importance to you, please contact the relevant office. The Agents have not tested any apparatus, equipment, fittings or services and so cannot verify they are in working order. The buyer is advised to obtain verification. Please note all the measurement details are approximate and should not be relied upon as exact. All plans, floor plans and maps are for guidance purposes only and are not to scale. Under no circumstances should they be relied upon as exact or for use in planning carpets and other such fixtures, fittings or furnishings. YOUR HOME IS AT RISK IF YOU DO NOT KEEP UP REPAYMENTS ON A MORTGAGE OR OTHER LOAN SECURED ON IT. 'A Life Assurance policy may be requested.' 'Written Quotations of credit terms available on request.'

Banner Cross  
T: 0114 268 3241  
E: [bannercross@saxtonmee.co.uk](mailto:bannercross@saxtonmee.co.uk)  
[www.saxtonmee.co.uk](http://www.saxtonmee.co.uk)

Hathersage  
T: 01433 650009  
E: [hathersage@saxtonmee.co.uk](mailto:hathersage@saxtonmee.co.uk)

Bakewell  
T: 01629 815307  
E: [bakewell@saxtonmee.co.uk](mailto:bakewell@saxtonmee.co.uk)

Matlock  
T: 01629 828250  
E: [matlock@saxtonmee.co.uk](mailto:matlock@saxtonmee.co.uk)

